

Pages 47, 259, & 260 of the document titled "HWY 75 Streambank Plans" have been substituted for by the materials in this document.

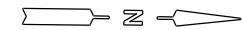

LIMITS OF RIPRAP PROTECTION & RIPRAP EROSION CONTROL GEOTEXTILE & WILLOW SHOOTS (SEE PLANTING PLAN) (TYP.)
 PROPOSED STORM DRAIN, (TYP.) (SEE ROADWAY PLANS)

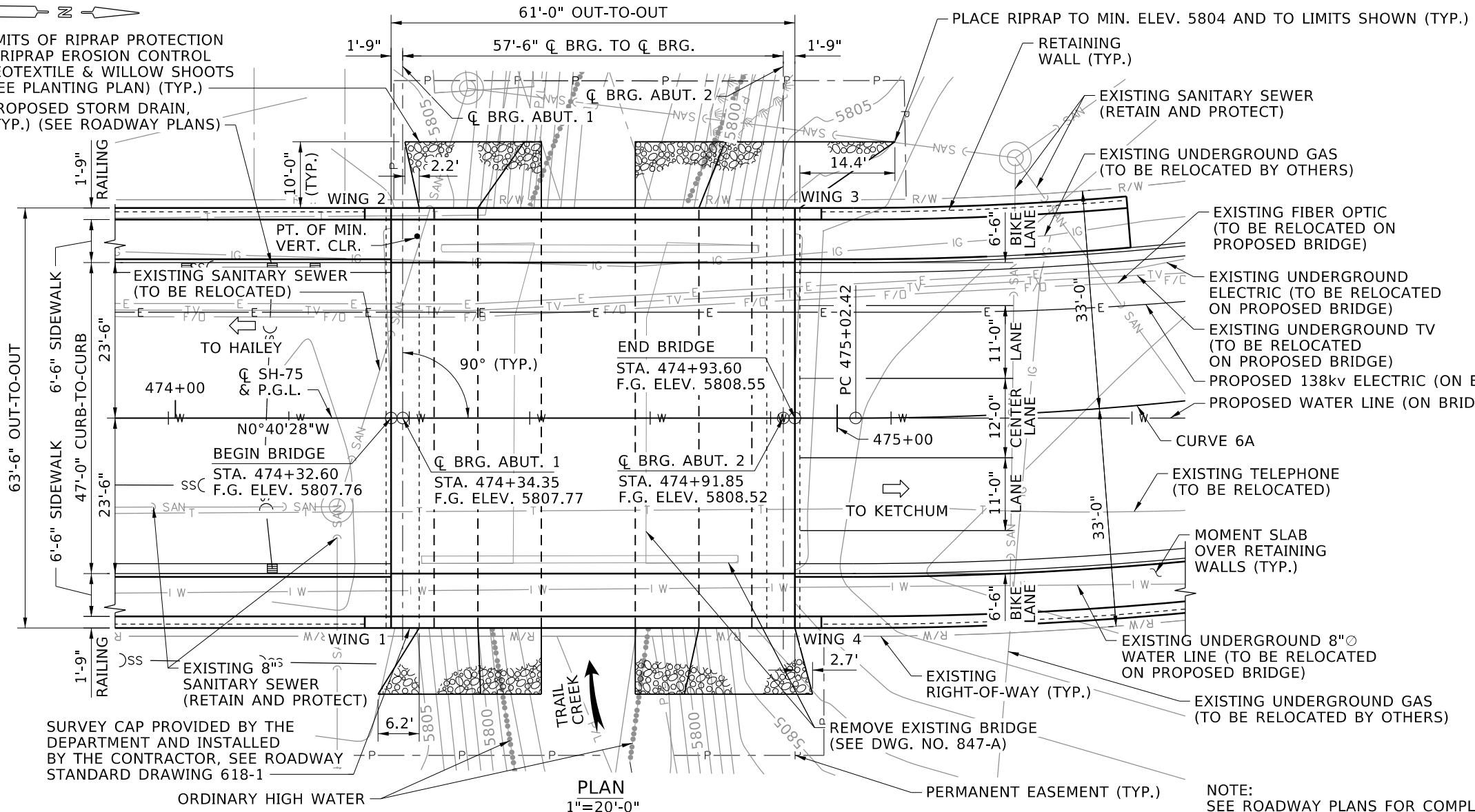

HYDRAULIC DATA			
FLOOD	DISCHARGE	H.W. ELEV.	VELOCITY
DESIGN (Q ₅₀)	900 cfs	5801.63 ft.	5.62 fps
BASE (Q ₁₀₀)	1020 cfs	5801.95 ft.	5.88 fps
SCOUR (Q _{5C})	1300 cfs	5802.62 ft.	6.40 fps

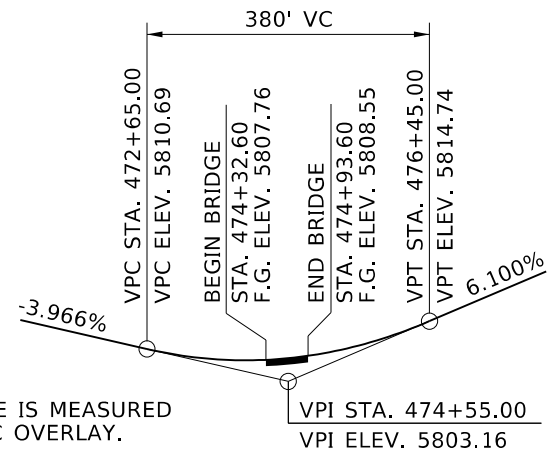

NOTE: PROFILE GRADE IS MEASURED AT TOP OF PPC OVERLAY.

PROFILE DATA - SH-75
NTS

HORIZONTAL ALIGNMENT
CURVE DATA

SH-75

CURVE 6A

PI=477+11.2721
 $\Delta=43^\circ 41' 58''$ LT.
 T=208.85'
 L=397.26'
 R=520.86'
 S=2%

NOTE: SEE ROADWAY PLANS FOR COMPLETE PROPOSED UTILITY LOCATIONS.

PLAN
1"=20'-0"

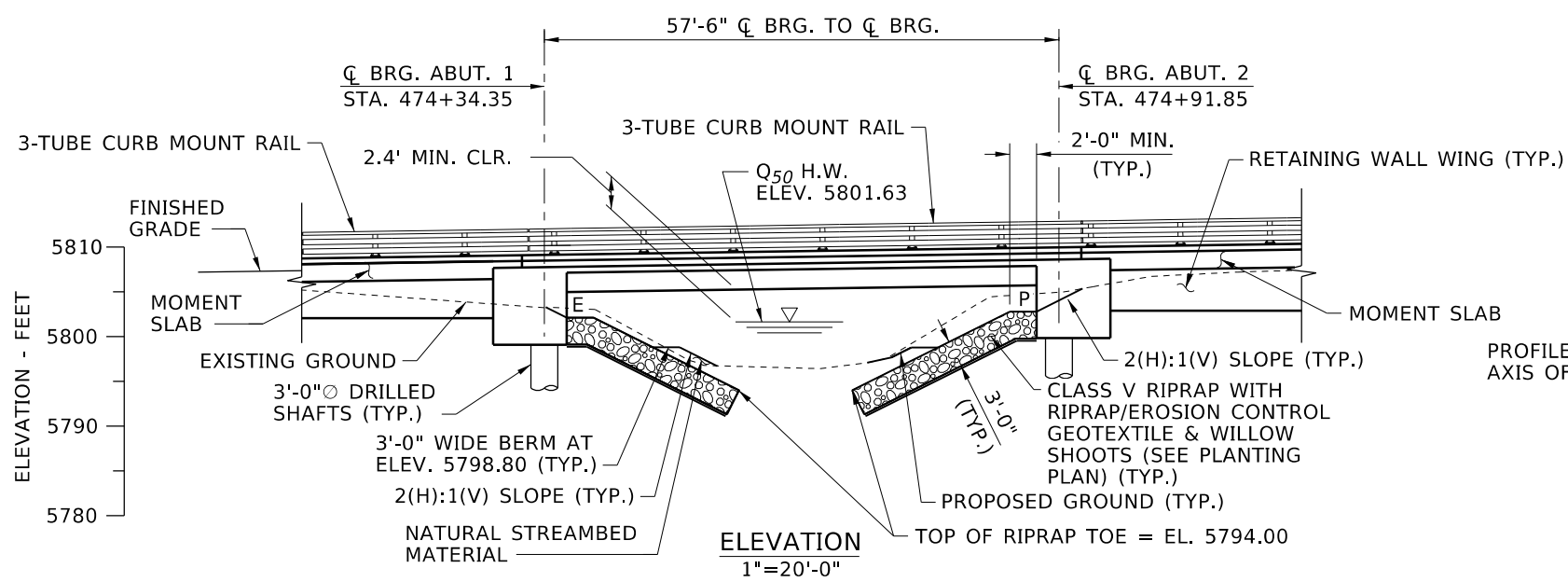

ELEVATION
1"=20'-0"

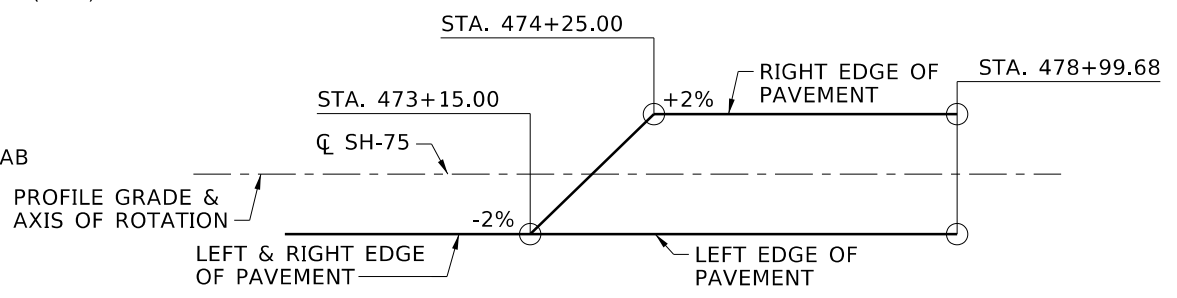

SUPERELEVATION DIAGRAM - SH-75
NTS

ORIGINAL STORED AT: ITD BRIDGE SECTION - Boise, Idaho

REVISIONS			
NO.	DATE	BY	DESCRIPTION

DESIGNED S. DANIEL	SCALES SHOWN ARE FOR 11" X 17" PRINTS ONLY
DESIGN CHECKED M. SLEGGERS	
DETAILED S. WALIMAA	
DWG. CHECKED M. SLEGGERS	
CORRECTIONS	

IDAHO TRANSPORTATION DEPARTMENT
 YOUR Safety → YOUR Mobility → YOUR Economic Opportunity

ENGLISH
 PROJECT NO.
 A020(033)

SITUATION AND LAYOUT
 61' PRESTRESSED VOIDED SLAB BRIDGE
 SH-75 OVER TRAIL CREEK
 STA. 474+63.10

BRIDGE PLANS	
BRIDGE KEY NO. 17676	KEY NO. 20033
COUNTY BLAINE	SHEET 1 OF 31
BRIDGE DWG. NO. 18076	

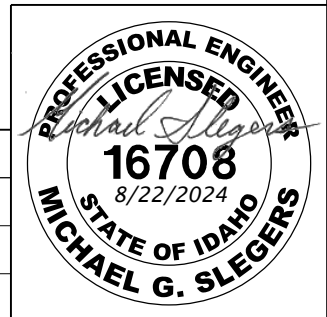

8/26/2024 2:49:06 PM
 U:\Bois\Projects\Clients\4006-ITD\314-4006-071\SH-75 Elkhorn to River\955vcs\CADD\DCN\sheets\20033_land_001.dgn

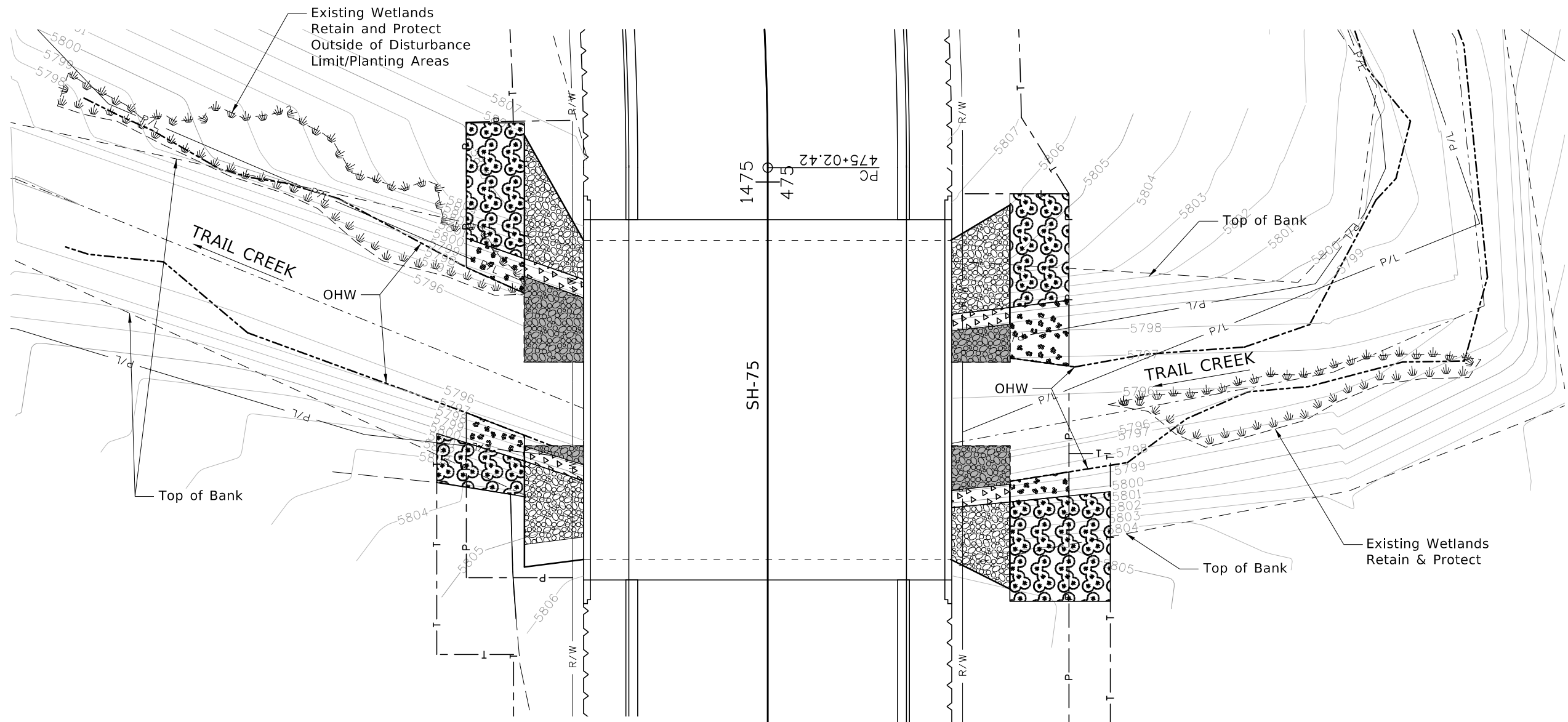

- 620-020A PLANTING TREE (SEEDLING OR CONTAINER)**
28 EACH 474+29.00 (58.00 L & 56.00 R) - 475+11.00 (51.00 L & 51.00 R)
 - 620-025A PLANTING SHRUB (BARE ROOT OR CONTAINER)**
20 EACH 474+29.00 (58.00 L & 56.00 R) - 475+11.00 (51.00 L & 51.00 R)
- NOTE:
SEE SWPP PLAN SHEETS FOR RIPARIAN SEED QUANTITIES

Table 1: Native Planting

Scientific Name	Common Name	Type	Percent by cover	Appx. Spacing (ft)
Planting Area 1-Shoreline				
<i>Populus trichocarpa</i>	Black Cottonwood	live stakes/poles	50	10
<i>Salix exigua</i>	Coyote Willow	live stakes/poles	50	5
Total Zone 1-Shoreline			100	
Planting Area 2-Riparian-Upland				
<i>Populus tremuloides</i>	Quaking Aspen	1-2-gallon	50	8
<i>Rosa Woodsii</i>	Woods Rose	1-2-gallon	50	8
Total Zone 2-Riparian			100	

*Planting Area 1- Within 5-10 ft of the stream (Roots should reach below the water table), Planting Area 2- Upslope from Planting Area 1

Construction Notes:

- o Live stakes/pole plantings to appx. 24-36" and buried so that the bottom of the stakes/poles are below the OHWM of Trail Creek. Should be buried with shoots upward and at least 3/4 of the pole should be buried.
- o Plants should be placed at a recommended spacing of and clustered with like species as possible

LEGEND

- Zone 1 Planting Area (Shoreline) With Riparian Seeding
- Zone 2 Planting Area (Riparian) With Riparian Seeding
- Coyote Willow Live Stakes/Poles in Riprap Areas (5' Spacing)
- Riprap areas
- Riprap Areas Underneath Natural Streambed Material

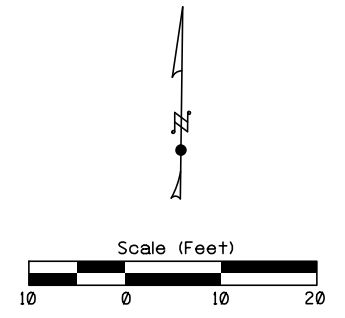

REVISIONS			
NO.	DATE	BY	DESCRIPTION

DESIGNED	JLJ	SCALES SHOWN ARE FOR 11" X 17" PRINTS ONLY
DESIGN CHECKED	TMJ	
DETAILED	JRA	CADD FILE NAME 20033_land_001.dgn
DRAWING CHECKED	PSA	DRAWING DATE: August 2024

IDAHO TRANSPORTATION DEPARTMENT
 YOUR Safety→YOUR Mobility→YOUR Economic Opportunity

Parametrix

PROJECT NO.
A020(033)

TRAIL CREEK PLANTING PLAN
SH-75, ELKHORN RD TO RIVER ST, KETCHUM

ENGLISH
 COUNTY Blaine
 KEY NUMBER 20033
 SHEET 263 OF 381